

Central Article Code: C68030D01-A
 Local Code: E60-N30-A

Created: 05/09/2005
 Modified: 15/12/2020

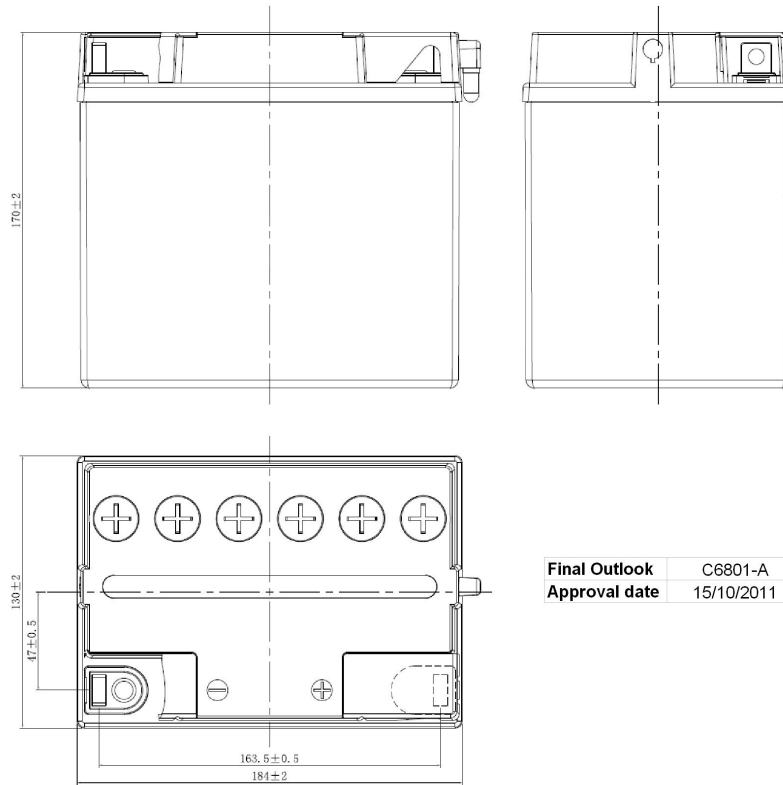

Final Outlook	C6801-A
Approval date	15/10/2011

PERFORMANCES		CONTAINER	
Voltage (V):	12 V	Type:	C68 WHITE
C20 (Ah):	30.0 10 h	Hold Down:	B0
Cranking (A):	300 EN	H.D. Adapter:	No
Charge:	DRY	COVER	
Technology:	Vented/Flooded	Type:	Motorbike (B ventilati BLACK
Grid:	Low Sb	Polarity:	ETN 0
Vibration:	Not Defined	Terminals:	M11
Endurance:	Not Defined	Terminal Adapter:	No
		SOCI:	No
		Ventilation:	Moto-B
		Filter:	No
		Lateral Plug:	No
STD. DIMENSIONS		PLUGS	
Length (mm ± 2):	185	Type:	6 x Moto Plug RED
Width (mm ± 2):	130	HANDLES	
Height (mm ± 2):	170	Type:	None
Total Weight (kg ± 5%):	8.90	OTHERS	
This is a dry battery supplied with bottles of sulphuric acid. Sale of acid to end users is forbidden by Eu.Reg.1148/2019. Dry batteries must be filled with acid before delivery to end users All figures show nominal values. Tolerances are according to EN50342 and applicable European Regulations.		Degassing Tube:	No
		EAC certified	