

Central Article Code: C64010G02-A

Created: 02/09/2005

Local Code:

Modified: 03/05/2018

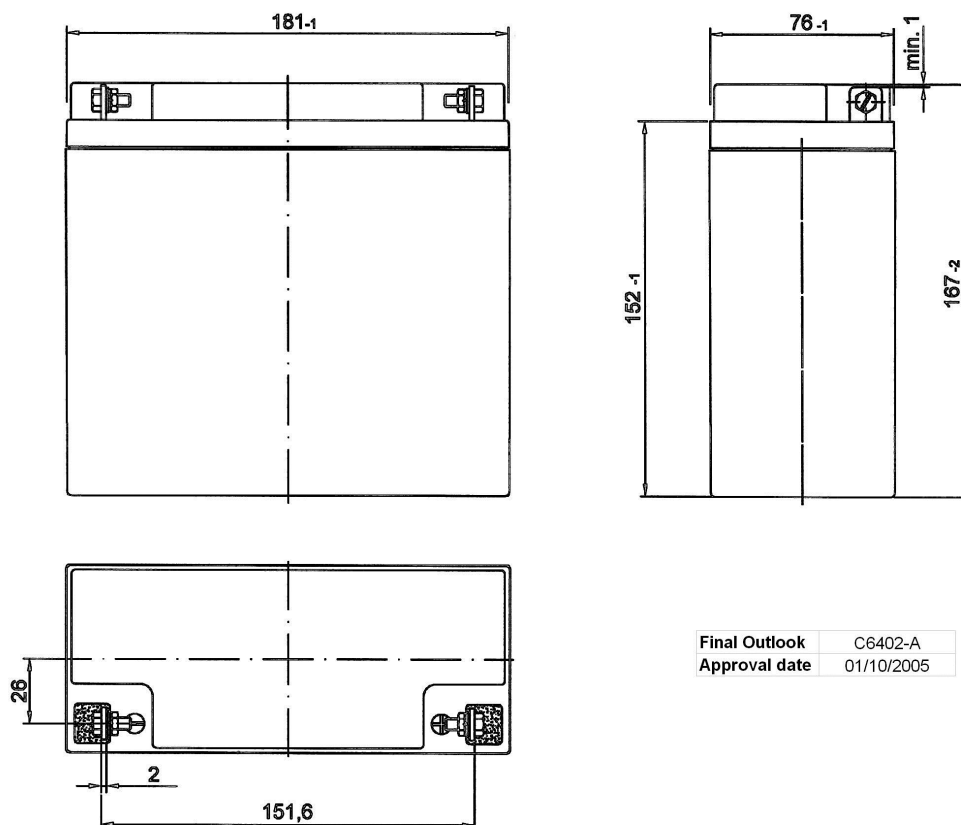

Final Outlook	C6402-A
Approval date	01/10/2005

PERFORMANCES

Voltage (V):	12 V	
C20 (Ah):	16.0	20 h
Cranking (A):	100	EN
Charge:	CHARGED	
Technology:	GEL	
Grid:	Ca/Ca	

CONTAINER

Type:	C64	GREY MEDIUM
Hold Down:	B0	
H.D. Adapter:	No	

COVER

Type:	Flat/Screw	GREY MEDIUM
Polarity:	ETN 0	
Terminals:	M11	
Terminal Adapter:	No	
SOCI:	No	
Ventilation:	Independent	
Filter:	No	
Lateral Plug:	No	

STD. DIMENSIONS

Length (mm ± 2):	180
Width (mm ± 2):	75
Height (mm ± 2):	165

All figures show nominal values. Tolerances are according to EN50342 and applicable European Regulations.

PLUGS

Type:	6 x Valve+Cov	GREY MEDIUM
-------	---------------	-------------

HANDLES

Type:	None
-------	------

OTHERS

Degassing Tube:	No
-----------------	----